

**COMPATIBLE WITH SPRAY MASTER 350 AMP<sup>†</sup>- FOR BACK END SEE PAGE 128**

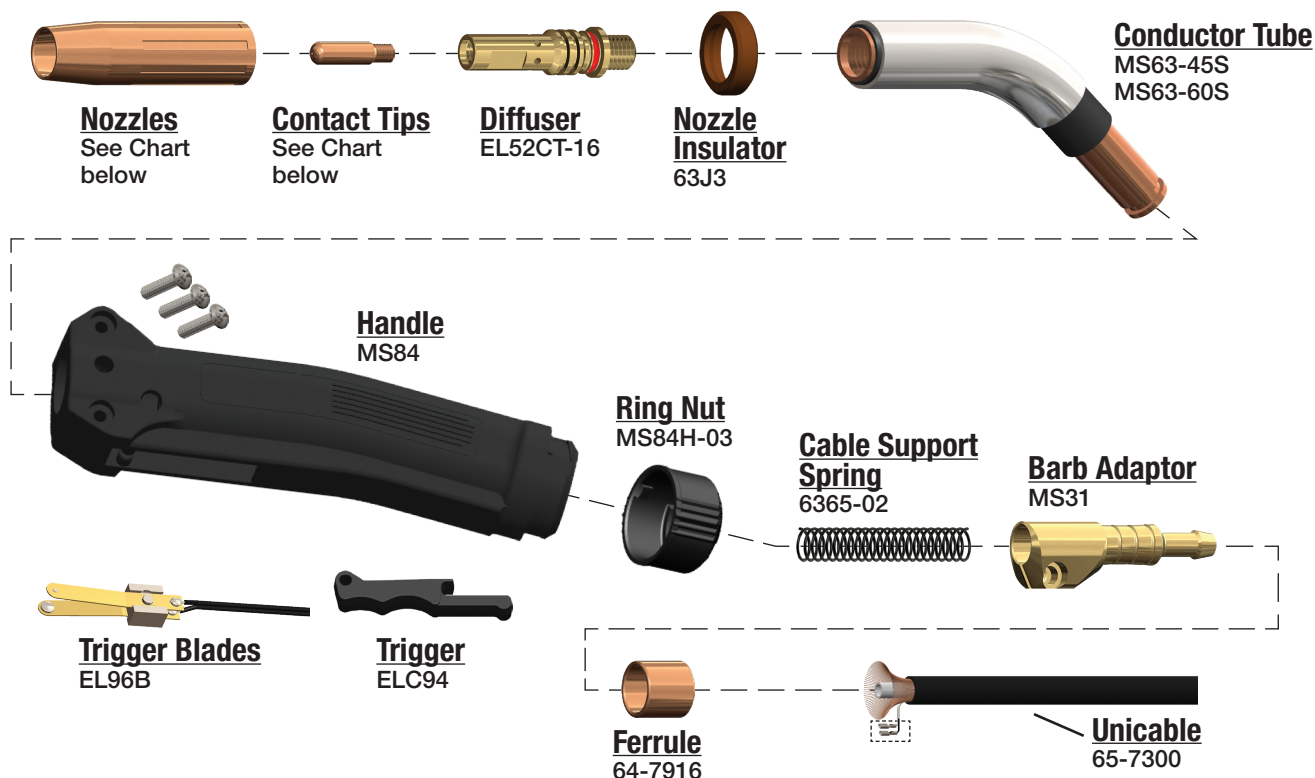

**MIG**

**STACK-UP CONTINUED ON PAGE 128**

**1. NOZZLES**

			<b>I.D.</b>
A	EL22CT-37	Nozzle Std. 1/8" Recess	3/8" (09.5mm)
	EL22CT-50	Nozzle Std. 1/8" Recess	1/2" (12.7mm)
	EL22CT-62	Nozzle Std. 1/8" Recess	5/8" (15.9mm)
	EL22CT-75	Nozzle Std. 1/8" Recess	3/4" (19.1mm)
B	EL22CT-50F	Nozzle Flush	1/2" (12.7mm)
	EL22CT-62F	Nozzle Flush	5/8" (15.9mm)
C	EL22CT-62H	Nozzle H.D.	5/8" (15.9mm)

**2. CONTACT TIP**

				<b>I.D.</b>
	16S-35	Contact Tip	.035 (0.9mm)	.044
	16S-40	Contact Tip	.040 (1.0mm)	.048
	16S-45	Contact Tip	.045 (1.2mm)	.054
	16S-52	Contact Tip	.052 (1.3mm)	.064
	16S-116	Contact Tip	1/16" (1.6mm)	.073
	16S-564	Contact Tip	5/64" (2.0mm)	.093
	16S-332	Contact Tip	3/32" (2.4mm)	.110
	16AS-364	Contact Tip	3/64" (1.2mm)AL	.059
	16AS-116	Contact Tip	1/16" (1.6mm)AL	.082

**LINERS**

				<b>I.D.</b>	<b>O.D.</b>
	44-116-15	Liner Assy.	15' 1/16"	.076	.188
	44-116-25	Liner Assy.	25' 1/16"	.076	.188
	44-3545-15	Liner Assy.	15' .035-.045	.066	.188
	44-3545-25	Liner Assy.	25' .035-.045	.066	.188

**COMPATIBLE WITH SPRAY MASTER 450 AMP<sup>†</sup>- FOR BACK END SEE PAGE 128**

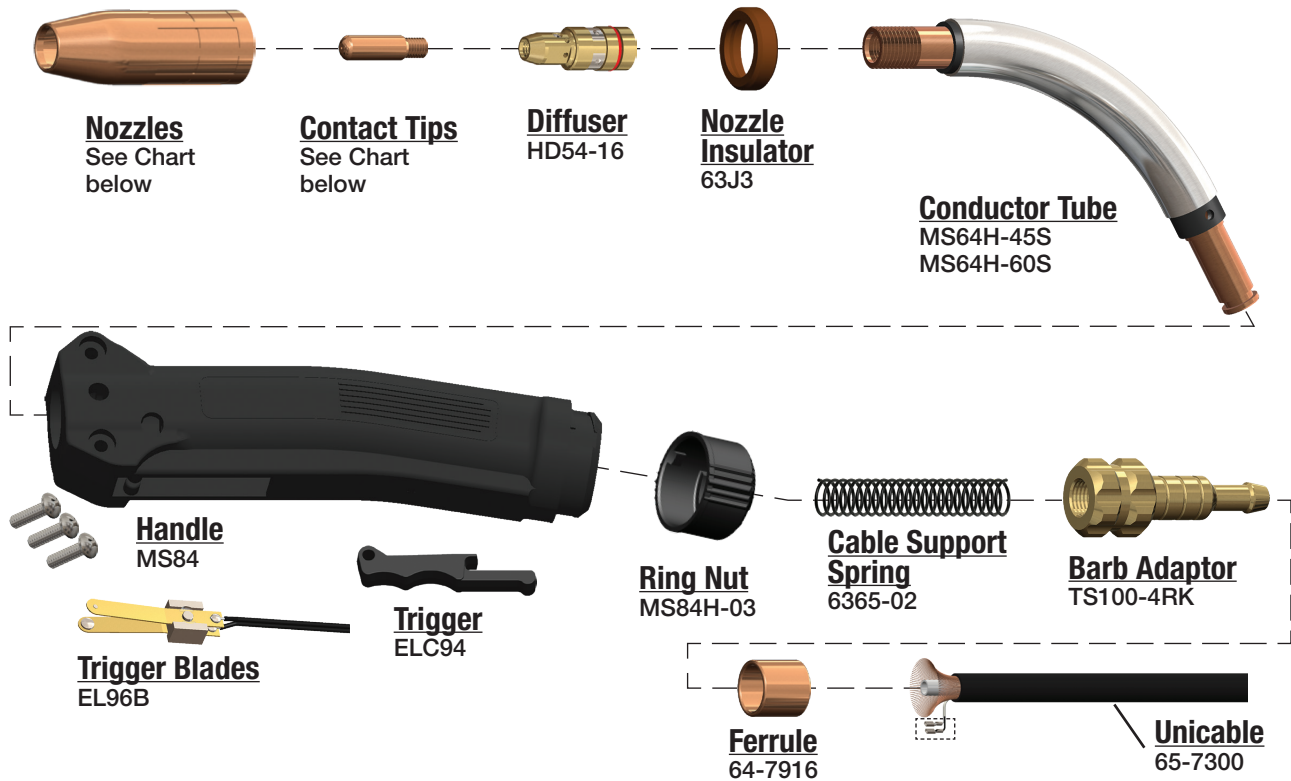

**MIG**

**STACK-UP CONTINUED ON PAGE 128**

## 1. NOZZLES

## I.D.

HD24L-50	Nozzle Std. Recess	1/2" (12.7mm)
HD24L-62	Nozzle Std.	5/8" (15.9mm)
HD24L-75	Nozzle Std.	3/4" (19.1mm)
HD24L-62F	Nozzle Flush.	5/8"
HD24-50	Nozzle H.D. Recess	1/8"
HD24-62	Nozzle H.D. Recess	5/8"
HD24-62F	Nozzle H.D. Flush	5/8"
HD24-75F	Nozzle H.D. Flush	3/4"

## 2. CONTACT TIP

## I.D.

16S-35	Contact Tip	.035 (0.9mm)	.044
16S-40	Contact Tip	.040 (1.0mm)	.048
16S-45	Contact Tip	.045 (1.2mm)	.054
16S-52	Contact Tip	.052 (1.3mm)	.064
16S-116	Contact Tip	1/16" (1.6mm)	.073
16S-564	Contact Tip	5/64" (2.0mm)	.093
16AS-364	Contact Tip	3/64" (1.2mm)AL	.059
16AS-116	Contact Tip	1/16" (1.6mm)AL	.082

## LINERS

44-116-15	Liner Assy.	15'	1/16"	.076	.188
44-116-25	Liner Assy.	25'	1/16"	.076	.188
44-3545-15	Liner Assy.	15'	.035-.045	.066	.188
44-3545-25	Liner Assy.	25'	.035-.045	.066	.188

## 128 **TWECO®** STYLE

COMPATIBLE WITH TWECO SPIT FIRE & SPRAY MASTER ASSEMBLIES† BACK END

CONTINUATION OF TWECO SPIT FIRE & SPRAY MASTER STACK-UPS  
FROM PAGES 122-127

MIG

