

## 300AP, 400M/MP system Packages Assembly Instructions.

### 300AP System Package assembly.

- See 300AP Operators manual for detailed setup instructions.
- Air Cooled System Package 300AP-ACTK does not include Coolant Recirculator.
- Water cooled system Packages 300AP-HDWTK, 300AP-WTK Assembly.

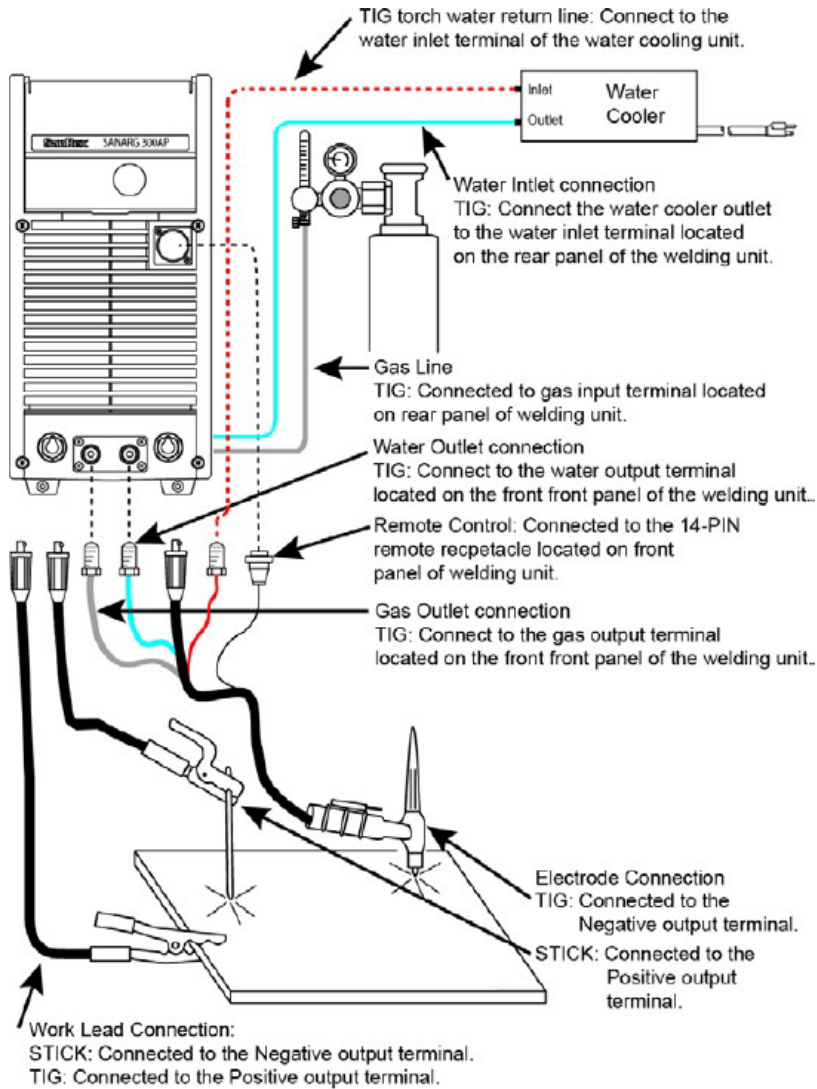

- Coolant Recirculator Blue Fitting - Coolant Out. Connect included water hose to Blue Coolant out fitting on Coolant Recirculator to coolant IN on the back panel of 300AP.
- Coolant Recirculator Red Fitting - Coolant In. Connect TIG Torch return Coolant line to Red Coolant IN on Coolant recirculator.
- Connect TIG Torch Coolant Supply Hose to 300AP front Panel Water Out Fitting.
- Coolant Recirculator Reservoir requires 1 and 2/3 Gallons of coolant.

## 400M/MP System Package Assembly

- See 400M/MP Operators manual for detail setup instructions.
- System Packages 400M-MK2, 400M-HDMK1T, 400M-HDMK1M, 400MP-MK2, 400MP-HDMK1T, 400MP-HDMK1M Assembly. Does not include Water Recirculator.

### Trolley Exploded View

- Items 4, 9, 13 – Used in MIG System Package.
- Item 1 - Wire Feeder Swivel Mount. Used in MIG System Packages.
  - Use supplied Allen Bolt hardware to attach to Top Tray.
- Water Recirculator Installs inside Item 9. Item 4 not used.
- To attach item 10 Vertical Cylinder Support Frame.
  - Use 4 each Supplied 13mm hex head bolts, Flat Washers, and lock Washers.
- To attach item 2 Top Tray to item 10 Vertical Cylinder Support Frame.
  - Use 2 each Supplied Allen 6mm bolts, Flat washer & Lock Washers.
- Item 5 Bracket used to support Top Tray to Power Supply.
- Item 3 Bracket used to attach Power Supply to Trolley.

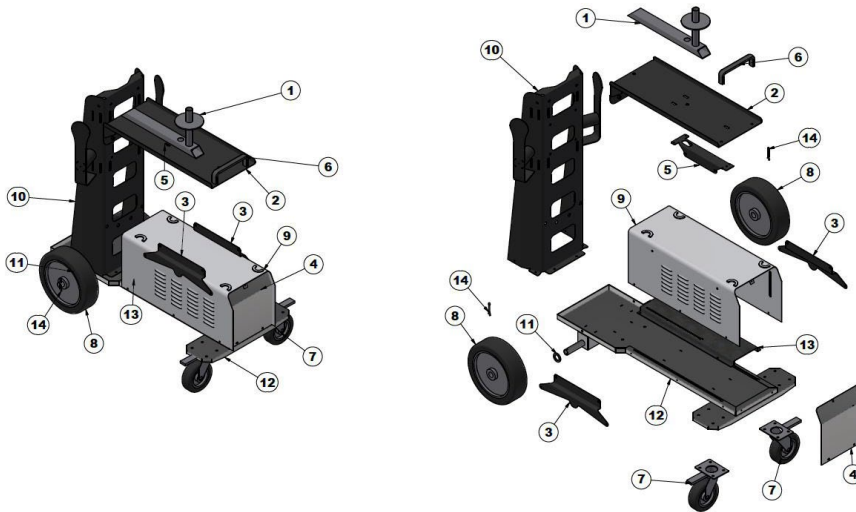

Allen 6mm Bolts